

BATTERY OPERATED RATTAN LANTERN

BATTERY INSTALLATION

Your LED candles each require 2 AA type 1.5V alkaline batteries (not included) to achieve maximum battery life (up to about 300 hours of candlelight).

1. To open battery compartment, turn the candle upside down, remove the 6 screw to open the battery compartment.
2. Insert 2 AA type batteries into the compartment in the proper polarity as shown.
3. Close the battery compartment.

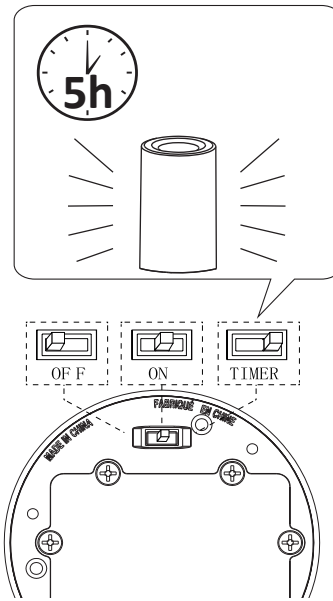

HOW TO OPERATE THE CANDLE AND TIMER ON/OFF MODE"

1. Put the switch in the ON position to turn the candle on.
2. To turn the candle off, put the switch in the OFF position.

"TIMER" MODE

1. To set the 5-hours timer, put the switch in the TIMER position.
 2. The following day, if the settings have not been modified, the candle will automatically turn on at the same time and will turn off after 5 hours.
 4. To change the starting time, put the switch in the OFF position and back to the TIMER position.
 5. To deactivate the "TIMER", put the switch in the OFF position.
- To clean your candle lantern, use a soft, dry cloth.

CAUTION

- Avoid contact with standing water and protect from extreme weather.
- To increase the lifespan of your lantern, store indoors when not in use.
- This product contains a LED flameless candle. To avoid hazard, do not light the wick.
- Failure to insert batteries in the correct polarity, as indicated, may shorten the battery life or may cause them to leak.
- Replace all batteries at the same time.
- Do not mix Alkaline, Standard (Carbon-Zinc) or Rechargeable (Nickel Cadmium or Nickel Metal Hydride) batteries.
- Remove batteries if exhausted or if product is to be left unused for a long period of time.
- Do not dispose of batteries in fire.
- This is not a toy. For decorative use only. The lantern can be used indoors or outdoors.
- Batteries should be recycled or disposed of as per manufacturer's recommendations.

